

CITY OF ST. CHARLES

ORDINANCE NO. 1995-M-43

AN ORDINANCE AMENDING CHAPTER 10.40, "STOPPING,
STANDING AND PARKING," OF THE
ST. CHARLES MUNICIPAL CODE

ADOPTED BY THE
CITY COUNCIL
OF THE
CITY OF ST. CHARLES
THIS 2ND DAY OF OCTOBER, 1995

PUBLISHED IN PAMPHLET FORM BY
AUTHORITY OF THE CITY COUNCIL
OF THE CITY OF ST. CHARLES,
KANE AND DU PAGE COUNTIES,
ILLINOIS, THIS 6TH DAY OF
OCTOBER, 1995

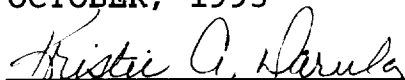
CITY CLERK

(S E A L)

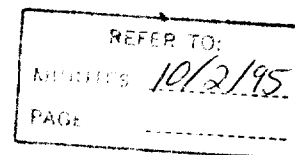
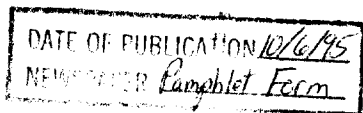

AN ORDINANCE NO. 1995-M- 43

**AN ORDINANCE AMENDING CHAPTER 10.40,
"STOPPING, STANDING AND PARKING,"
OF THE ST. CHARLES MUNICIPAL CODE**

**BE IT ORDAINED BY THE CITY COUNCIL OF THE CITY OF ST.
CHARLES, KANE AND DU PAGE COUNTIES, ILLINOIS AS
FOLLOWS:**

1. That Title 10, "Vehicles and Traffic," Chapter 10.40, "Stopping, Standing and Parking," Section 10.40.040, "No-Parking Places Designated-Prohibited Parking," of the St. Charles Municipal Code, be and is hereby amended by deleting Subparagraphs P, Q, and R and Exhibits NP-A-22, NP-A-27, NP-A-28, NP-A-33, NP-A-34, NP-A-35, NP-A-36, and NP-D substituting the following revised Exhibits NP-A-22, NP-A-27, NP-A-28, NP-A-33, NP-A-34, NP-A-35, NP-A-36, and NP-D, and the following revised text therefore:

- "P. At the parking area of the Riverside Lift Station which is located on the west side of Illinois Route 25 south of the Prairie Street Bridge and further described as follows:
the northerly side of the lift station to a line 132 feet southerly of and parallel with the southerly side of the lift station. However, such limitation on parking shall not apply to vehicles owned by the City of St. Charles. This sign designating no parking at that facility shall state, 'No Parking except for city-owned vehicles.'
- Q. At any place where street cleaning signs have been erected at the direction of the Chief of Police or his designee.

R. No parking is allowed in any area shown in Exhibits NP-A-13 through NP-A-36 and NP-A-DU-30 and special notes in Exhibits NP-B, NP-C, AND NP-D. The clarification notes set forth in Exhibit NP-D are intended to give greater detail to the areas shown in Exhibits NP-A-13 through NP-A-36 and NP-A-DU-30."

2. That after the adoption and approval hereof the Ordinance shall (i) be printed or published in book or pamphlet form, published by the authority of the Council, or (ii) within thirty days after the adoption and approval hereof, be published in a newspaper published in and with a general circulation within the City of St. Charles.

PRESENTED to the City Council of the City of St. Charles, Illinois, this 2nd day of October, 1995.

PASSED by the City Council of the City of St. Charles, Illinois, this 2nd day of October, 1995.

APPROVED by the Mayor of the City of St. Charles, Illinois, this 2nd day of October, 1995.

Mayor

ATTEST:

City Clerk

COUNCIL VOTE:

Ayes: 14

Nays: 0

Absent: 0

APPROVED AS TO FORM:

City Attorney

DATE: 10/4

STOPPING, STANDING AND PARKING

EXHIBIT NP-D

- 23-1 NO PARKING ON THE WESTERLY SIDE OF FOXWOOD COURT, FROM THE BEGINNING OF TURNAROUND AS NOTED ON EXHIBIT NP-B TO A POINT 355 FEET NORTHERLY THEREOF.
- 25-1 NO PARKING ON THE EAST SIDE OF FIELDGATE DRIVE FROM EAST MAIN STREET TO A POINT 180 FEET NORTH OF THE NORTHERLY RIGHT OF WAY OF EAST MAIN STREET.
- 25-2 NO PARKING ON THE WEST SIDE OF FIELDGATE DRIVE FROM EAST MAIN STREET TO A POINT 180 FEET NORTH OF THE NORTHERLY RIGHT OF WAY OF EAST MAIN STREET.
- 25-3 NO PARKING ON EITHER SIDE OF THE FRONTAGE ROAD, LOCATED ON THE SOUTH SIDE OF EAST MAIN STREET, FROM THE WESTERLY RIGHT OF WAY OF KAUTZ ROAD TO THE EASTERLY RIGHT OF WAY OF 38TH AVENUE, AND FROM THE WESTERLY RIGHT OF WAY OF 38TH AVENUE TO A POINT AT WHICH THE FRONTAGE ROAD ENDS TO THE WEST.
- 25-4 NO PARKING ON THE NORTH SIDE OF PRODUCTION DRIVE FROM THE WESTERLY RIGHT OF WAY OF KIRK ROAD TO A POINT 100 FEET WESTERLY THEREOF.
- 26-1 NO PARKING ON THE WESTERLY SIDE OF TYLER ROAD FROM THE NORTHERLY RIGHT OF WAY OF EAST MAIN STREET, TO THE SOUTHERLY RIGHT OF WAY OF WING LANE EXTENDED SOUTHWESTERLY.
- 26-2 NO PARKING ON THE EAST SIDE OF LONGMEADOW CIRCLE FROM THE NORTHERLY RIGHT OF WAY OF IROQUOIS AVENUE TO A POINT 700 FEET NORTHERLY THEREOF.
- 26-3 NO PARKING ON THE WEST SIDE OF LONGMEADOW CIRCLE FROM THE POINT WHERE THE TURNAROUND BEGINS AS NOTED ON EXHIBIT NP-B TO A POINT 253 FEET NORTHERLY THEREOF.
- 27-1 NO PARKING ON THE SOUTHERLY SIDE OF NORTH AVENUE FROM THE WESTERLY RIGHT OF WAY OF SECOND AVENUE TO THE EASTERLY RIGHT OF WAY OF SHABBONA AVENUE EXTENDED SOUTHERLY.
- 27-2 NO PARKING ON THE EASTERLY SIDE OF THIRD AVENUE FROM A POINT 560 FEET SOUTHERLY OF DELNOR AVENUE RIGHT OF WAY AND ON THE EASTERLY, SOUTHERLY, WESTERLY, AND NORTHERLY SIDE OF NORTH THIRD AVENUE FROM A POINT 560 FEET SOUTHERLY OF THE DELNOR AVENUE RIGHT OF WAY THROUGH THE MERGING WITH DELNOR AVENUE TO FIFTH AVENUE EXCEPT FOR THE 110 FEET WEST OF FIFTH AVENUE ON THE SOUTHERLY SIDE OF DELNOR AVENUE.

- 27-3 NO PARKING ON THE WESTERLY SIDE OF FIRST AVENUE FROM THE NORTHERLY RIGHT OF WAY LINE OF CEDAR AVENUE TO A POINT 110 FEET NORTHERLY THEREOF.
- 27-4 NO PARKING ON THE WESTERLY SIDE OF NORTH ELEVENTH AVENUE FROM THE SOUTHERLY RIGHT OF WAY OF WING AVENUE TO A POINT 400 FEET SOUTHERLY THEREOF.
- 27-5 NO PARKING ON THE EAST SIDE OF NORTH ELEVENTH AVENUE FROM A POINT 400 FEET SOUTH OF THE RIGHT OF WAY OF WING AVENUE TO A POINT 763.2 FEET SOUTH OF THE SOUTH RIGHT OF WAY OF WING AVENUE.
- 27-6 NO PARKING ALONG THE EAST SIDE AND WEST SIDE OF SOUTH 7TH AVENUE FROM THE NORTH RIGHT OF WAY OF ILLINOIS AVENUE, EXTENDED NORTHERLY 45 FEET.
- 27-7 NO PARKING ALONG THE EAST SIDE OF THIRD AVENUE FROM THE NORTH RIGHT OF WAY OF DELNOR AVENUE EXTENDED TO THE NORTH 300 FEET THEREOF.
- 27-8 NO PARKING ON THE EAST SIDE OF SOUTH FOURTH AVENUE, FROM THE SOUTHERLY RIGHT OF WAY OF WALNUT AVENUE TO A POINT 20 FEET SOUTH. NO PARKING ON THE EAST SIDE OF SOUTH FOURTH AVENUE, FROM A POINT 42 FEET SOUTH, TO A POINT 134 FEET SOUTH OF THE SOUTHERLY RIGHT OF WAY OF WALNUT AVENUE. NO PARKING ON THE EAST SIDE OF SOUTH FOURTH AVENUE FROM THE NORTHERLY RIGHT OF WAY OF ILLINOIS AVENUE TO A POINT 20 FEET NORTH. (Ord. 1994-M-39 § 1.)
- 27-9 NO PARKING ALONG THE SOUTH SIDE OF ILLINOIS AVENUE FROM THE WESTERLY RIGHT OF WAY OF SOUTH SEVENTH AVENUE TO A POINT 66 FEET WESTERLY THEREOF.
- 27-10 NO PARKING ALONG THE EAST SIDE OF SOUTH SEVENTH AVENUE FROM THE SOUTHERLY RIGHT OF WAY OF ILLINOIS AVENUE TO A POINT 66 FEET SOUTHERLY THEREOF.
- 28-1 NO PARKING ON THE SOUTHERLY SIDE OF TIMER TRAIL, FROM THE EASTERLY RIGHT OF WAY OF CARROL ROAD, TO THE WESTERLY RIGHT OF WAY OF MILLINGTON WAY.
- 28-2 NO PARKING ON THE SOUTHERLY SIDE OF STATE STREET, FROM THE WESTERLY RIGHT OF WAY OF SEVENTH STREET, TO THE WESTERLY PROPERTY LINE OF LOT 40.
- 28-3 NO PARKING ON THE SOUTHERLY SIDE OF DEAN STREET FROM THE WESTERLY RIGHT OF WAY OF FIFTEENTH STREET TO THE WEST CORPORATE BOUNDARY.
- 33-1 NO PARKING ON THE WESTERLY SIDE OF FOURTEENTH STREET FROM THE NORTH RIGHT OF WAY LINE OF ROUTE 38 (LINCOLN HIGHWAY) TO A POINT 350 FEET SOUTH OF HORNE STREET.

- 33-2 NO PARKING ON THE SOUTHERLY SIDE OF FAIRVIEW DRIVE FROM THE WESTERLY RIGHT OF WAY OF NINETEENTH STREET TO A POINT 225 FEET WESTERLY THEREOF.
- 33-3 NO PARKING ON THE WEST SIDE OF FAIRVIEW DRIVE FROM THE NORTHERLY RIGHT OF WAY OF OAK STREET TO THE NORTH PROPERTY LINE OF LOT 45.
- 33-4 NO PARKING ALONG THE SOUTH SIDE OF ILLINOIS STREET FROM THE EAST RIGHT OF WAY OF SOUTH 10TH STREET, EXTENDED WESTERLY 30 FEET.
- 33-5 NO PARKING ALONG THE EAST SIDE OF SOUTH 10TH STREET FROM THE SOUTH RIGHT OF WAY OF ILLINOIS STREET, EXTENDED NORTHERLY 30 FEET.
- 33-6 NO PARKING ON THE SOUTHERLY SIDE OF PRAIRIE STREET, FROM THE WESTERLY RIGHT OF WAY LINE OF SEVENTH STREET TO A POINT 350 FEET THEREOF WEST OF SEVENTH STREET.
- 33-7 NO PARKING ON THE EAST SIDE OF SOUTH 12TH STREET, FROM THE SOUTH RIGHT OF WAY OF OAK STREET TO A POINT 330 FEET SOUTHERLY THEREOF.
- 34-1 NO PARKING ON THE EASTERLY SIDE OF THIRD STREET FROM THE NORTHERLY RIGHT OF WAY OF PRAIRIE STREET TO THE SOUTHERLY RIGHT OF WAY OF OAK STREET EXTENDED EASTERLY.
- 34-2 NO PARKING ON THE EASTERLY SIDE OF THIRD STREET FROM THE SOUTHERLY RIGHT OF WAY OF PRAIRIE STREET TO THE NORTHERLY RIGHT OF WAY OF PRAIRIE STREET TO THE NORTHERLY RIGHT OF WAY OF MOODY STREET EXTENDED EASTERLY.
- 34-3 NO PARKING ON THE SOUTHERLY SIDE OF HORNE STREET FROM THE WESTERLY RIGHT OF WAY OF GENEVA ROAD TO A POINT 420 FEET WESTERLY THEREOF.
- 34-4 NO PARKING ALONG THE SOUTH SIDE OF WALNUT STREET FROM THE WEST RIGHT OF WAY LINE OF SOUTH 5TH STREET, EXTENDED WESTERLY 45 FEET.
- 34-5 NO PARKING ON THE WEST SIDE OF SIXTH AVENUE FROM THE SOUTHERLY RIGHT OF WAY OF SPRING AVENUE TO THE EASTERLY RIGHT OF WAY OF RIVERSIDE AVENUE.
- 34-6 NO PARKING ON THE WEST OF SIXTH AVENUE FROM THE SOUTHERLY RIGHT OF WAY OF ADAMS AVENUE TO A POINT 60 FEET SOUTHERLY THEREOF.
- 34-7 NO PARKING ON THE EAST SIDE OF MONROE AVENUE FROM THE SOUTHERN RIGHT OF WAY OF SPRING AVENUE, EXTENDED SOUTHERLY TO THE END OF MONROE AVENUE.

LEGEND:



NO PARKING THIS SIDE OF STREET



NO PARKING ON SUNDAYS OR HOLIDAYS



SECTION 22

SEE SECTION 15

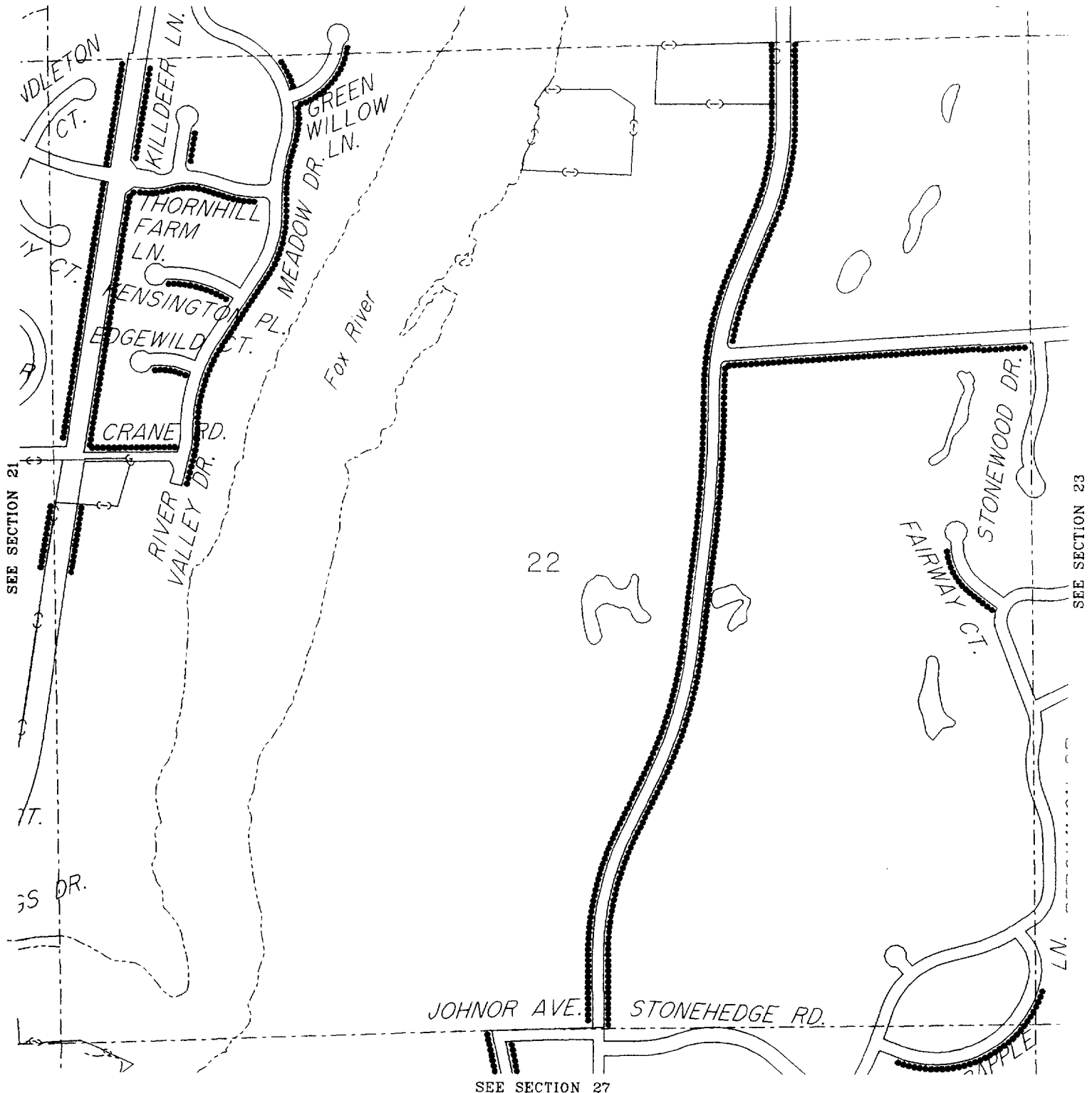

SEE SECTION 27

LEGEND:

- NO PARKING THIS SIDE OF STREET
 NO PARKING ON SUNDAYS OR HOLIDAYS



SECTION 27

SEE SECTION 22

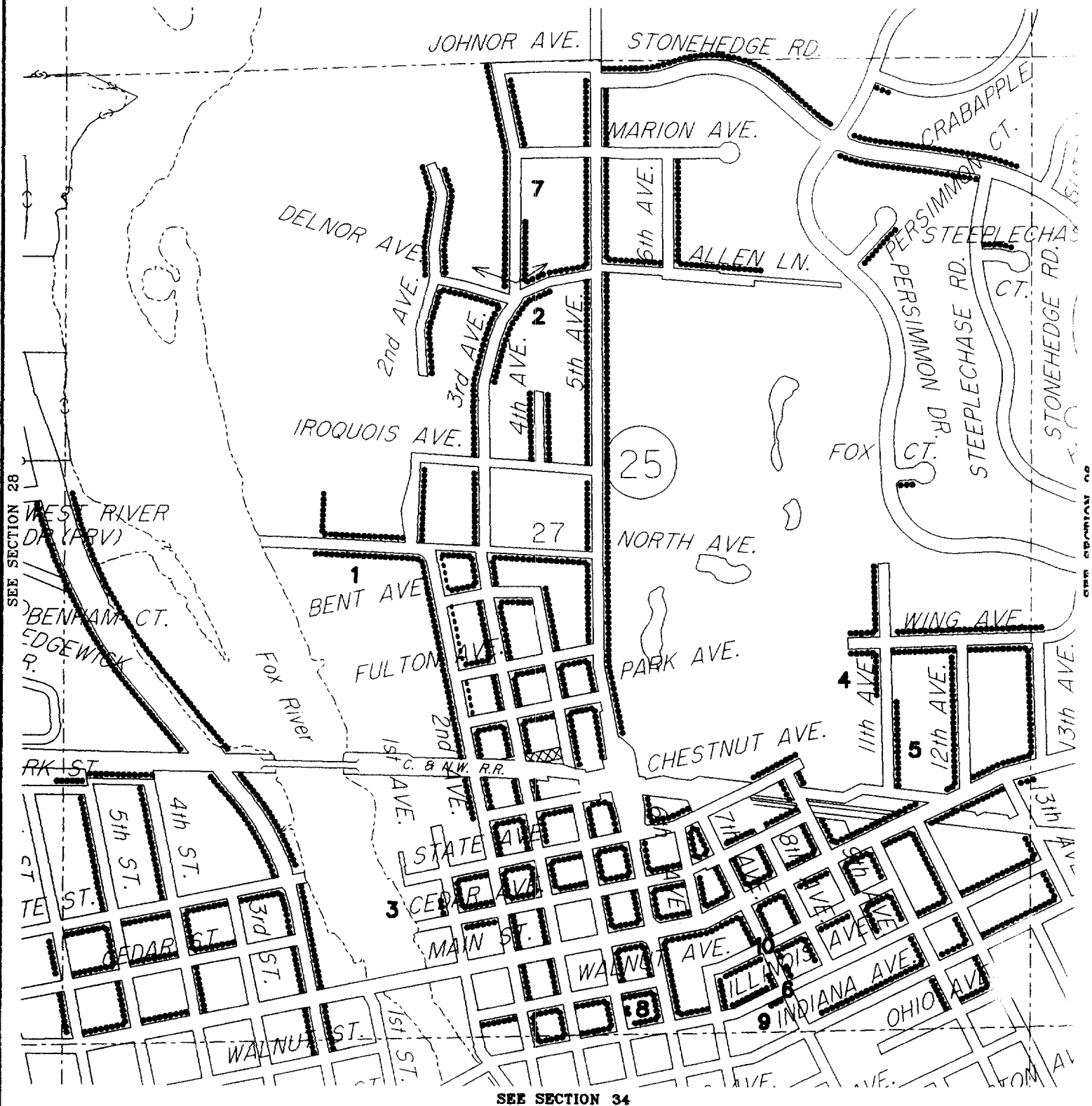

SEE SECTION 34

LEGEND:

- NO PARKING THIS SIDE OF STREET
 - - - - - NO PARKING ON SUNDAYS OR HOLIDAYS



SECTION 28

SEE SECTION 21

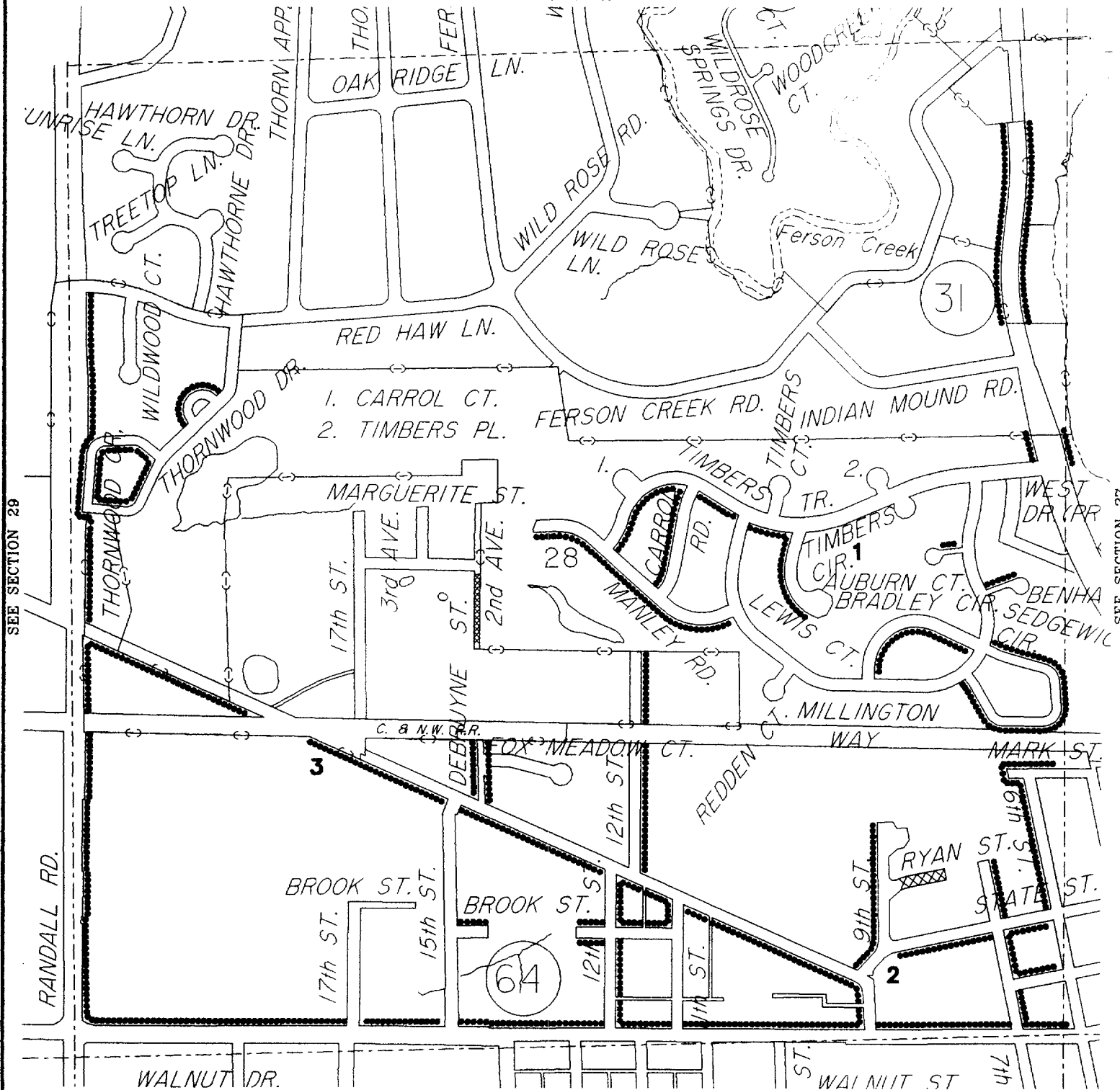

SEE SECTION 33

..... NO PARKING THIS SIDE OF STREET
..... NO PARKING ON SUNDAYS OR HOLIDAYS



SECTION 33

SEE SECTION 28

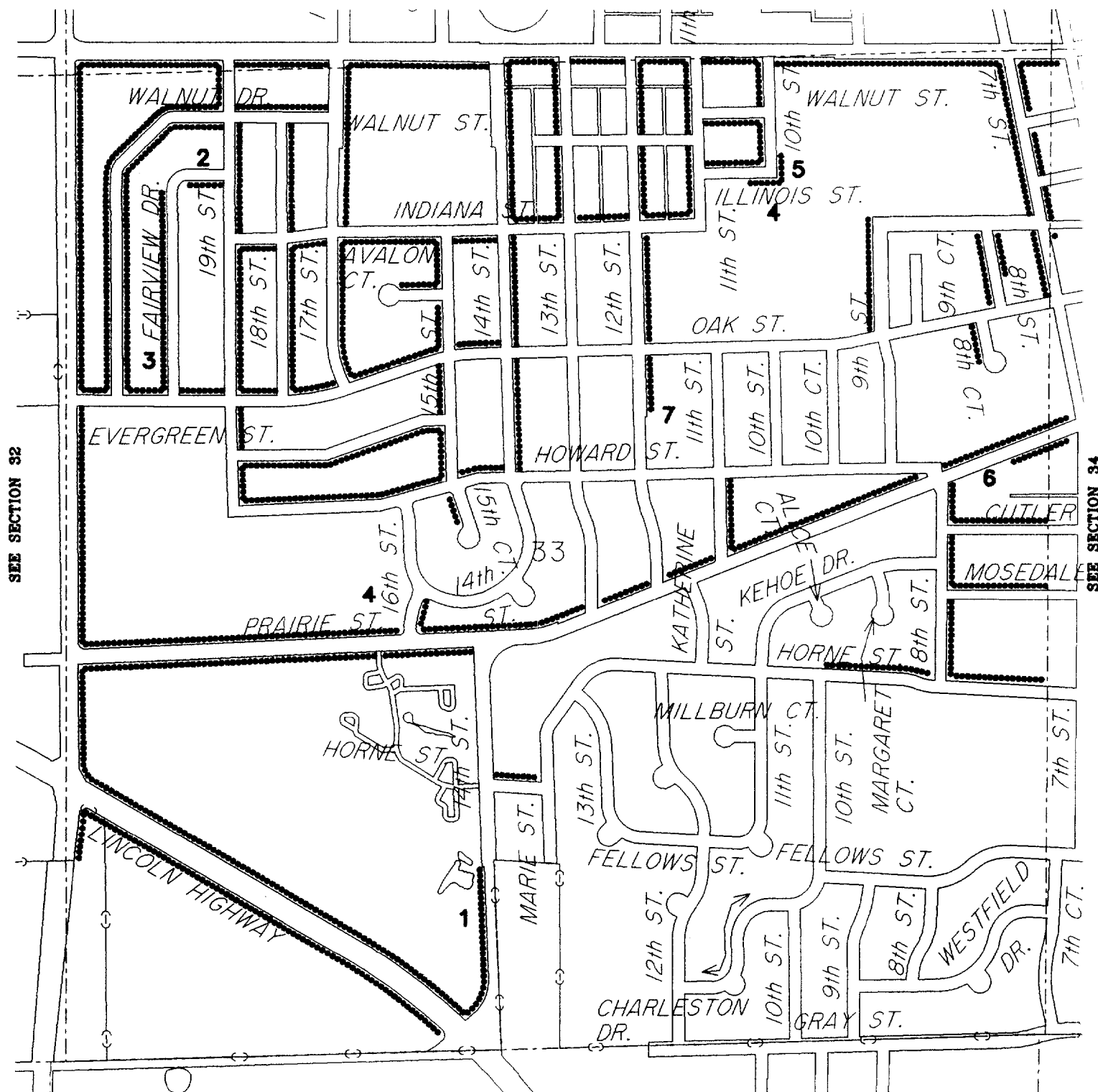

LEGEND:

- NO PARKING THIS SIDE OF STREET
 - - - - - NO PARKING ON SUNDAYS OR HOLIDAYS



SECTION 34

SEE SECTION 27



SEE SECTION 33

SEE SECTION 35

LEGEND:



NO PARKING THIS SIDE OF STREET

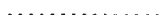

NO PARKING ON SUNDAYS OR HOLIDAYS



SECTION 35

SEE SECTION 26

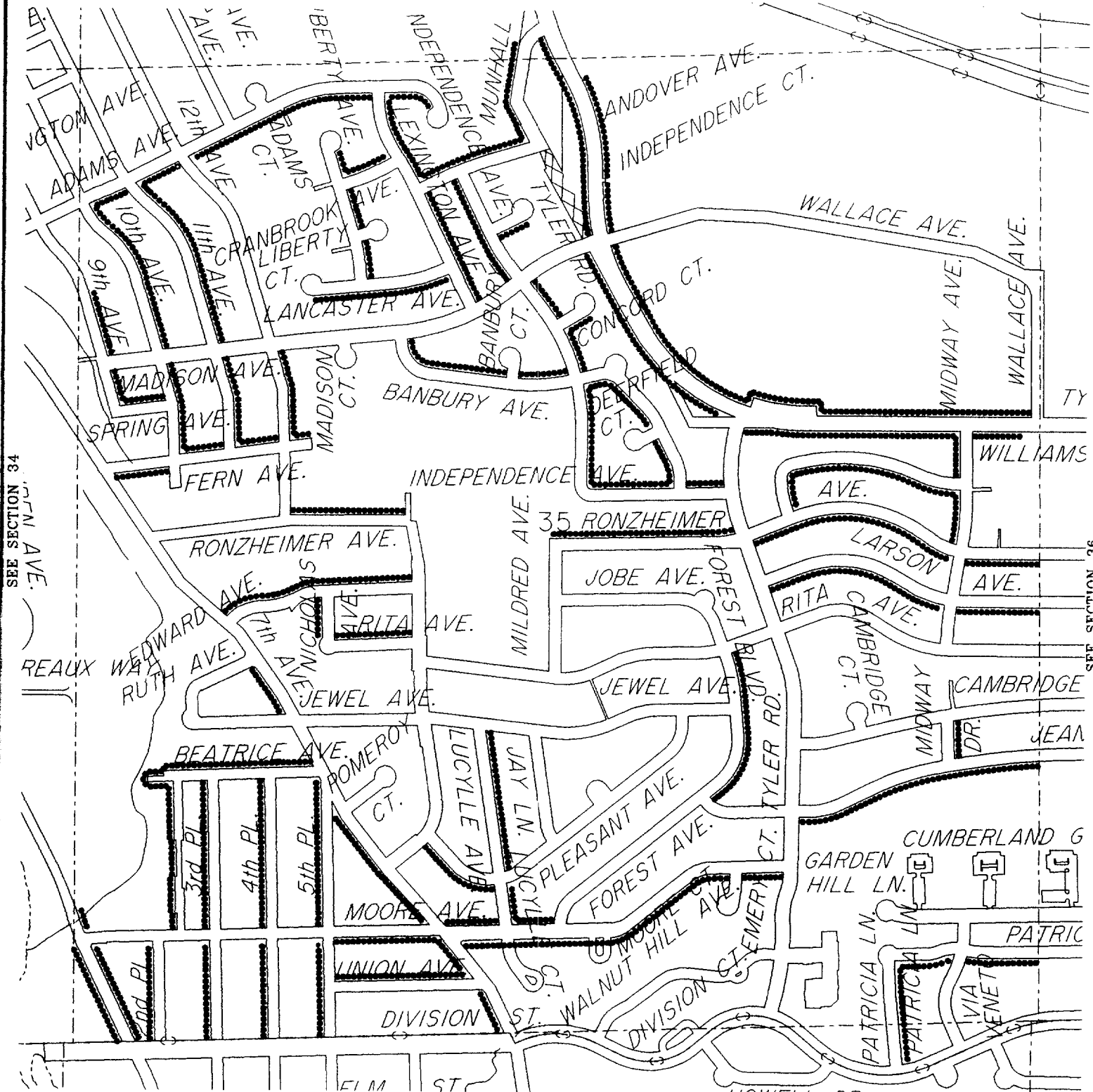

LEGEND:



NO PARKING THIS SIDE OF STREET



NO PARKING ON SUNDAYS OR HOLIDAYS



SECTION 36

SEE SECTION 25

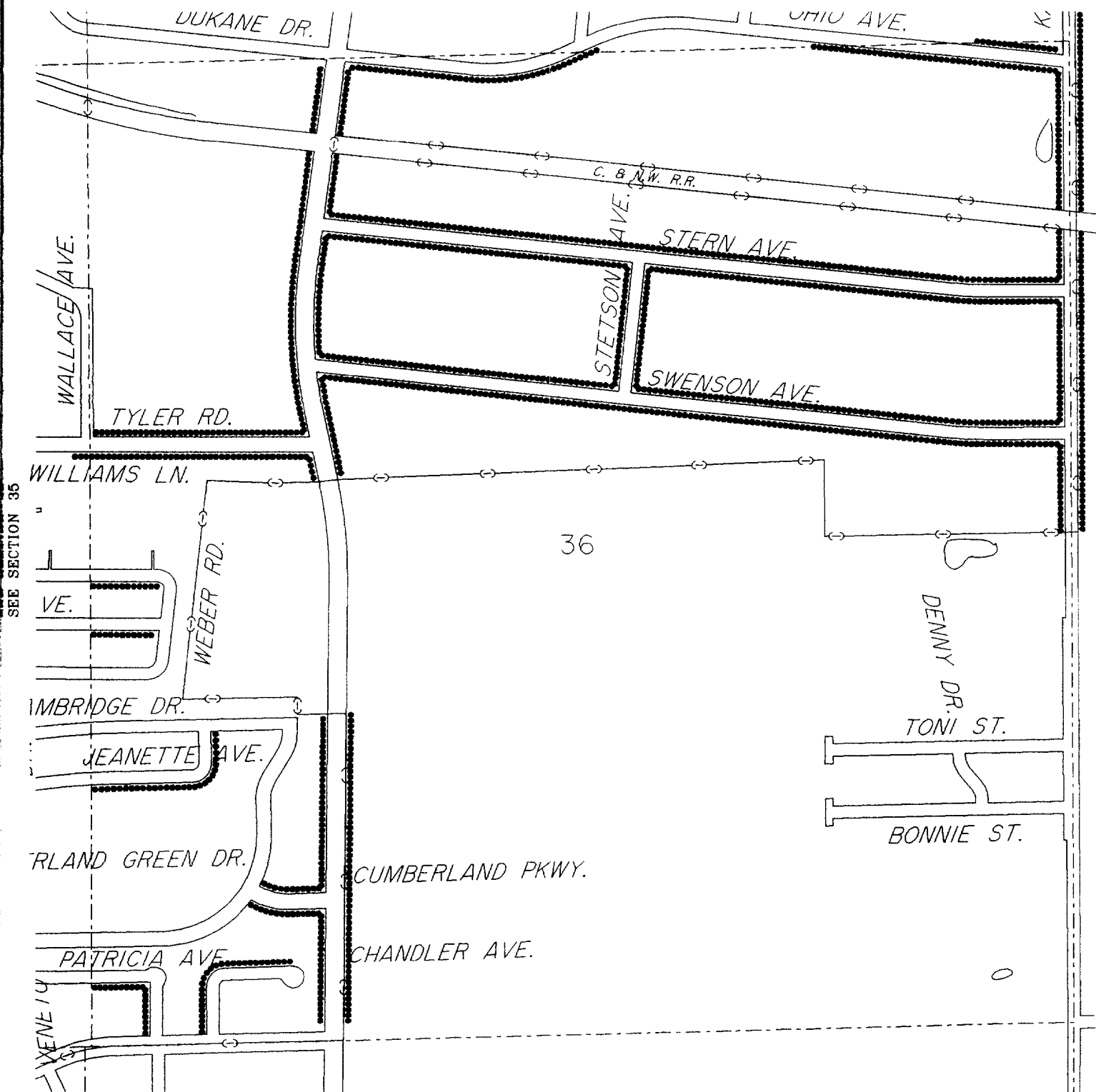

STATE OF ILLINOIS)
) SS.
COUNTIES OF KANE AND DUPAGE)

C E R T I F I C A T E

I, KRISTIE A. DARULA, certify that I am the duly elected and acting municipal clerk of the city of St. Charles, Kane and DuPage Counties, Illinois.

I further certify that on October 2, 1995, the Corporate Authorities of such municipality passed and approved Ordinance No. 1995-M-43, entitled

"AN ORDINANCE AMENDING CHAPTER 10.40, 'STOPPING, STANDING AND PARKING,' OF THE ST. CHARLES MUNICIPAL CODE",

which provided by its terms that it should be published in pamphlet form.

The pamphlet form of Ordinance No. 1995-M-43, including the Ordinance and a cover sheet thereof was prepared, and a copy of such Ordinance was posted in the municipal building, commencing on October 6, 1995, and continuing for at least ten days thereafter. Copies of such Ordinance were also available for public inspection upon request in the office of the municipal clerk.

DATED at St. Charles, Illinois, this 4th day of
October, 1995.

Kristi A. Larus
Municipal Clerk

(S E A L)